

Make your own...

Paper Tea Cup & Saucer

The pattern on this cup and saucer is taken from a Coalport Tea set that was owned by a wine seller in Merthyr Tydfil in 1800 and is now displayed at Cyfarthfa Castle.

Colour in the cup and saucer first, then follow the instructions to make your own.

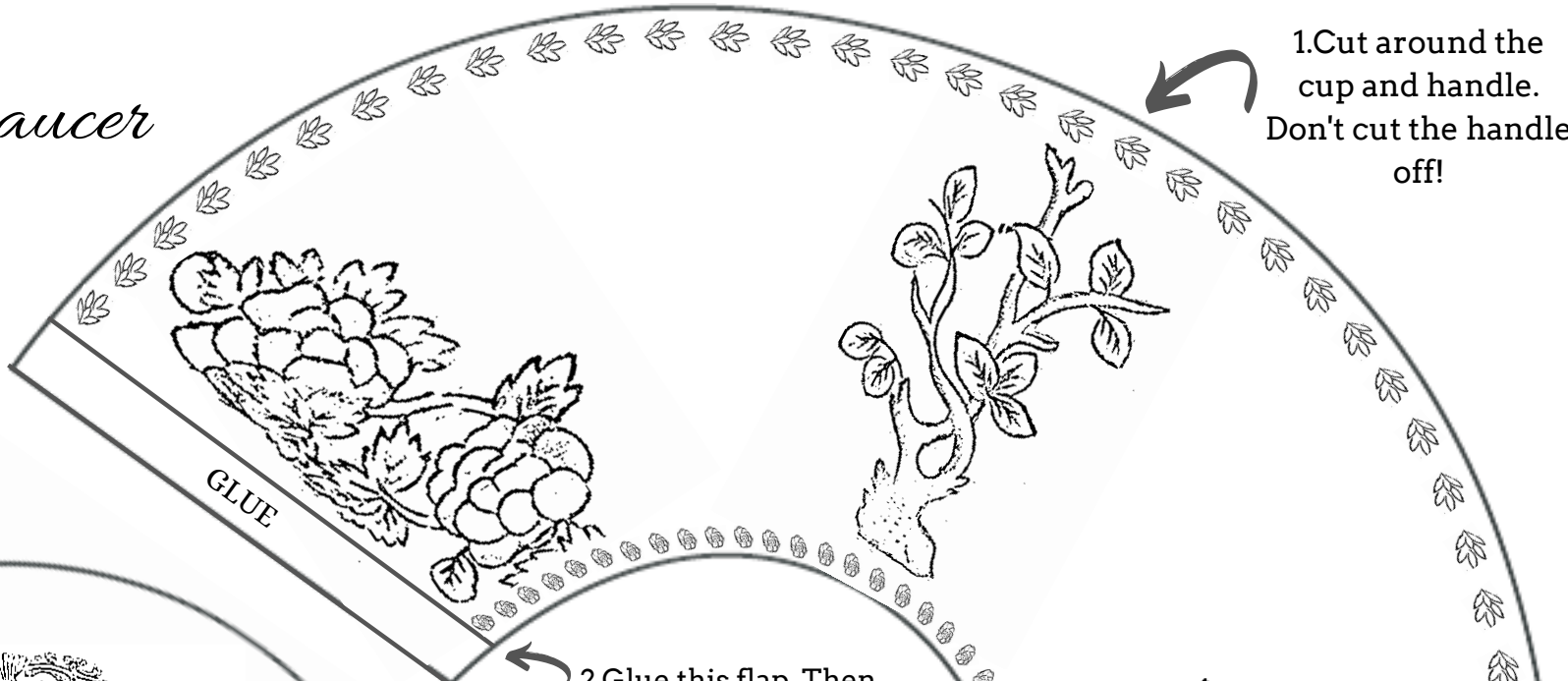

1. Cut around the cup and handle. Don't cut the handle off!

4. Cut out the saucer.

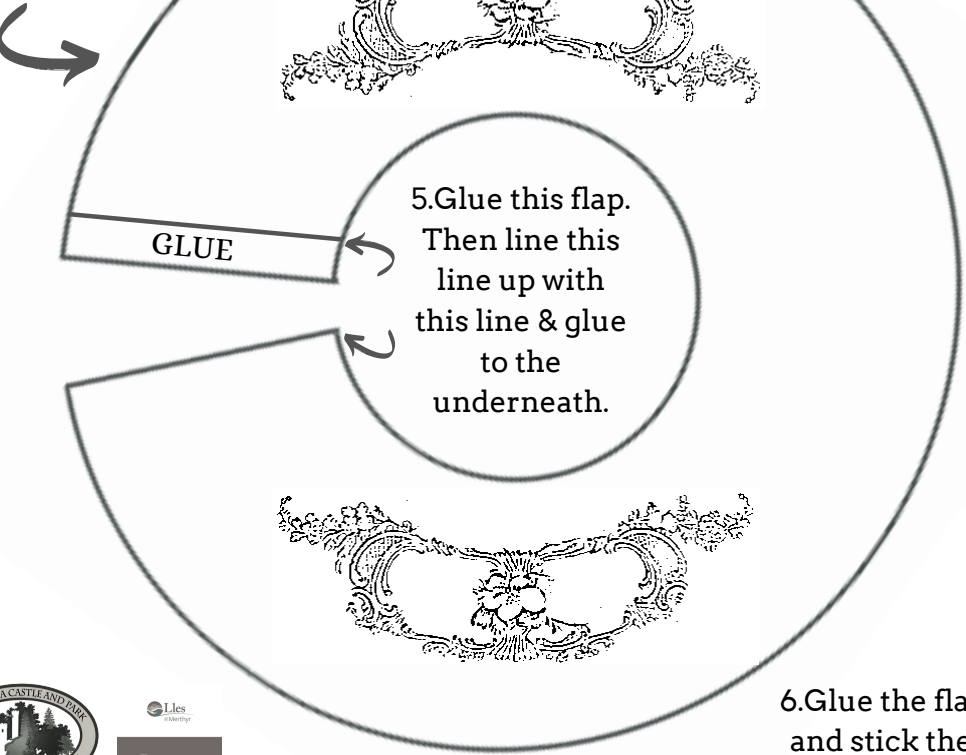

5. Glue this flap. Then line this line up with this line & glue to the underneath.

2. Glue this flap. Then line up this line with... this line. Then glue to the inside of the cup. You may need to fold the handle lightly so it stands out correctly

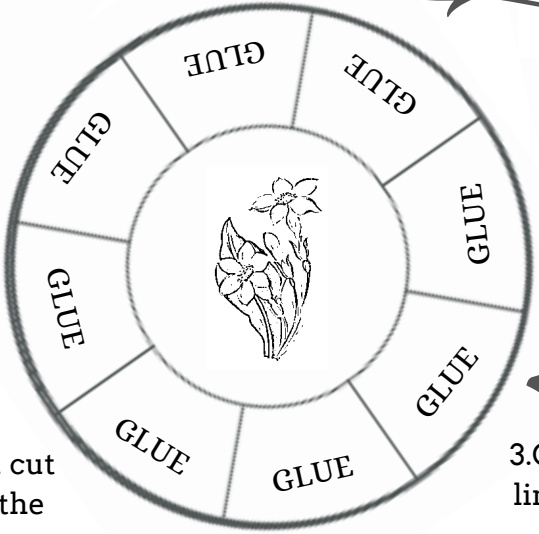

3. Cut the saucer base. Cut the straight lines too, but only until you reach the centre circle.

6. Glue the flap you cut and stick them to the underneath of the saucer.

